



Developing profitable customers



ORKEL POWERPACK **SPARE PARTS LIST**

This parts list

Version: PowerPack.PL.1B
From chassis number: 30028001

Instructions for ordering spare parts

Illustrated parts are marked with part numbers.

To avoid errors, each part order must include the following information:

- Part number and description of part
- Quantity of parts required
- Chassis number

The chassis number is stamped into the frame on the powerpack.

It is essential to quote this chassis number in full in all enquiries and spare part orders.

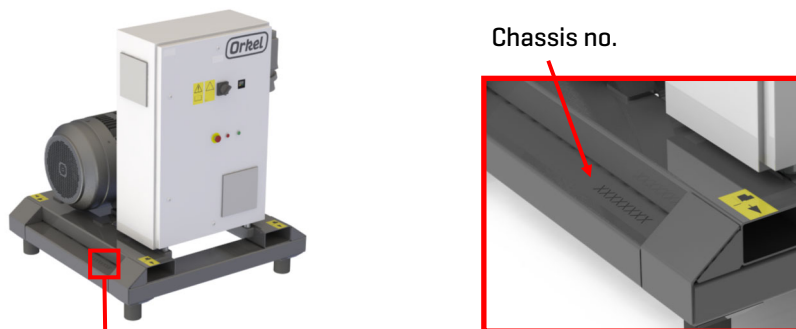

Disclaimer

The original parts used on an Orkel® machinery are designed and built to provide optimum fit, function, safety, and structural integrity. For this reason, Orkel® DOES NOT in any circumstance approve of the use of aftermarket, gray market, or imitation parts.

The information provided by Orkel® hereunder is provided “as is, where is” and with all faults, and the entire risk associated with such information is entirely with the Buyer.

Orkel® does not grant, explicitly or implicitly, to any party any patent rights, licenses, or any other IP rights, whether with regard to such information itself or anything described by such information.

Information provided in this document is proprietary to Orkel®, and Orkel® reserves the right, at its sole discretion, to make any changes or modification to the information in this document or to any products and services at any time without notice.

Orkel® does not assume responsibility for any damages associated with a machinery and/or part failure caused by the use of parts other than genuine Orkel® replacement parts, neither do we assume responsibility for any changes to the product made after initial delivery.



Johan Gjønnnes' veg 25
7320 Fannrem
Norway



Spare parts:
+47 913 23 511
Technical Support:
+47 918 43 553



parts@orkel.no



orkel.com



User resources
orkel.no/gr/powerpack

Part number	Qty	Description
79380	1	Sub frame
81002	1	Motor 55kW 6-pol
79376	1	Adaptor
79375	1	Flanged PTO tap
82283	1	Cabinet, complete
81003	1	Cabinet with converter
82284	1	Digital Temperature Controller
82285	1	Fan for cabinet
82286	1	Fan filter
82288	1	Main switch
82290	1	Emergency stop
79483	1	Wall inlet
79484	1	Connector
82279	1	Key for cabinet powerpack
81064	4	Rubber stopper ø100x100xM16
82347	1	
13040	4	Weld Nut M8 DIN 929
79648	1	PTO protection
12093	8	Washer 25 DIN 125A -140HV FZV
10655	4	Bolt M24x80
13217	4	Lock nut M24
12470	8	Wedge-locking washer, Schnorr, M8
11305	3	Set screw M12x20
15180	8	Bolt M8x40, cylinderhead
16005	4	Sticker P-039
16290	1	Logo Orkel
16292	1	Sticker Logo Orkel front, black
16114	1	Sticker
16004	1	Sticker P-004
16038	1	Sticker
81080	1	Adaptor M63-M50
81081	1	Nipple M50 EMC
12247	4	Spring washer 8,1 DIN 127 B FZV
10244	4	Bolt M8 x 20 DIN 933 8.8 FZV
59801	1	Cable gland M20 Ø6-12 Poly
81082	4	Rubber mount
12147	10	Washer 8,4 x 24 x 2 DIN 9021 FZV
13209	8	Lock nut M8
82601	4	Spacer, PTO-shield

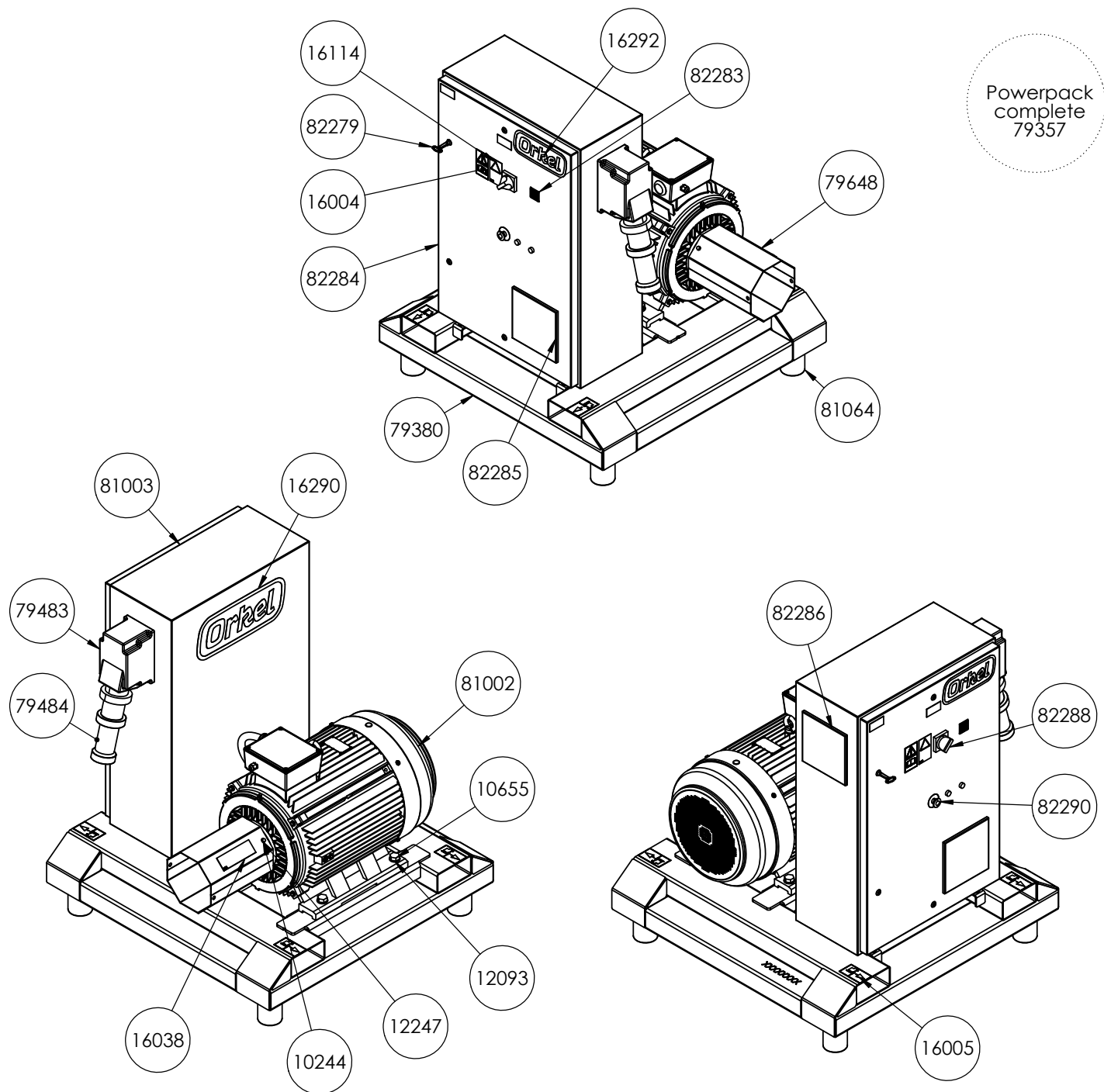

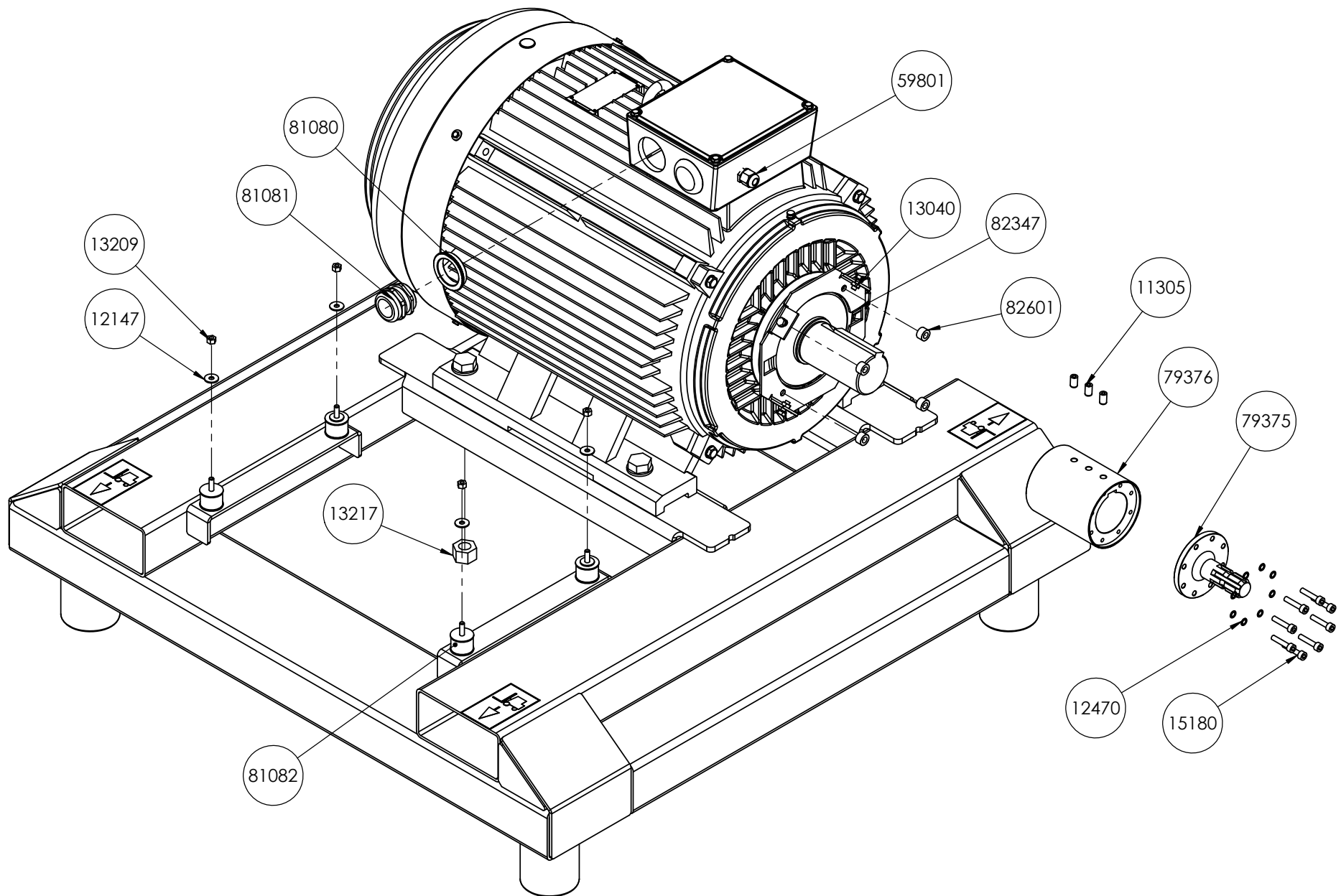

Part number	Qty	Description
82417	1	Pt100 sensor cable
82623	1	M12 Cable Gland
200498	1	Temperature sensor holder

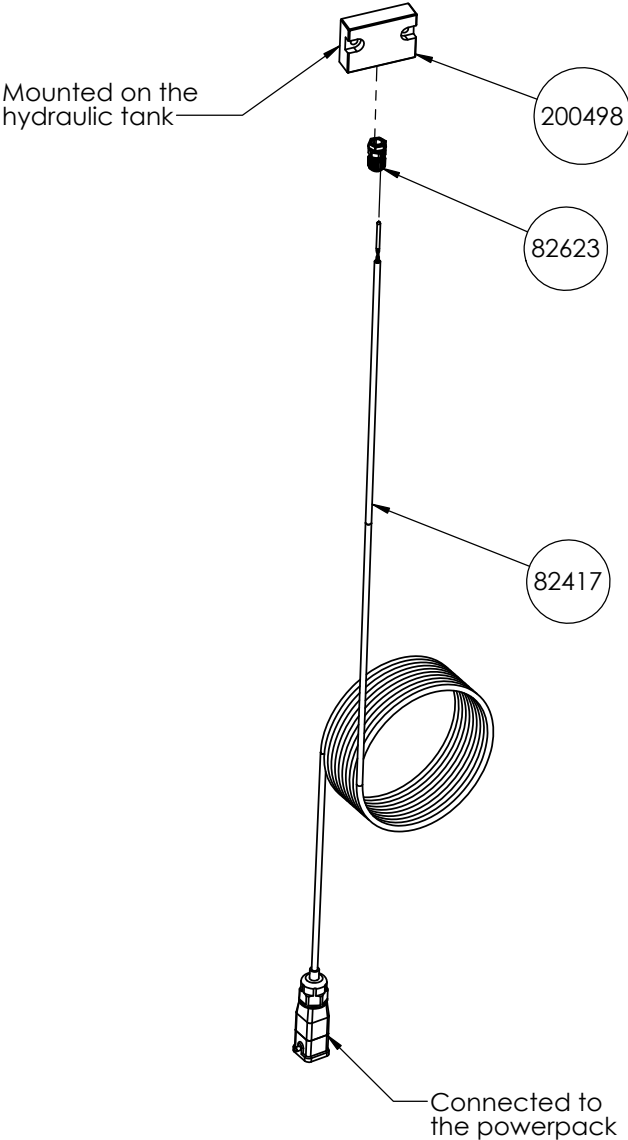



Developing profitable customers

CONTACT



Johan Gjønnnes' veg 25
7320 Fannrem
Norway



Spare parts:
+47 913 23 511

Technical Support:
+47 918 43 553



parts@orkel.no



orkel.com

User resources



orkel.no/qr/powerpack